

CPU iSCU th F

Ref. 27EV000018



TECHNICAL SPECIFICATIONS

GENERAL		
Technology	Patent pending	
Maximum load	≤15 W (Stand-by ≤1W)	
CPU Input voltage	12 V DC	
Ingress Protection Rating	IP53	
Hydraulic connections	1/2" & 3/8" M-GAS, John Guest	
Weight	0.4 kg	
TEMPERATURE	MINIMUM	MAXIMUM
Recommended input hot water range	48° C	65° C
Recommended input cold water range	5° C	28° C
Maximum inlet temperature	65° C *(1)	
Minimum inlet temperature	>0° C	
Mixed range	Full Cold – Full Hot	
PRESSURE		
Maximum dynamic	6 bar (0.6Mpa)	
Minimum dynamic	1 bar (0.1Mpa)	
Recommended dynamic	3 bar (0.3Mpa)	
Maximum differential supply	4.5 bar (0.45Mpa)	
Burst	>35 bar (3.5Mpa)	
FLOW RATE (3 bar free flow, DN8)	MINIMUM	MAXIMUM
Mixed water	2 L/min	22.5 L/min
Full Cold or Full Hot water	2 L/min	12.1 L/min

DESCRIPTION

Smart electronic device with digital reading and accurate, stable, thermostatic regulation of water temperature and flow rate at the point of use. Designed to be integrated in faucets.

FEATURING

- Thermostatic control
- Flow static control
- Automatic start-up
- Pause
- User memory
- Faucet parameters setup
 - Maximum water temperature
 - Maximum flow rate
 - Time of use
 - Time of pause
- Maintenance functions
 - Thermal disinfection
 - Impurity cleaning process
- Consumption parameters Reading and control
 - Hot and cold temperature (inlets) & mixed (outlet)
 - Hot and cold flow rate (inlets) & mixed (outlet)
 - Water volume (cold, hot, mixed)
 - Time of use
- Maintenance alarms and error diagnosis
 - Cold and hot water leakage
 - Cold and hot water failure
 - Hot water temperature low
 - Cold water temperature high
 - Sensor malfunction

CPU iSCU th F

Ref. 27EV000018

STANDARDS

ELECTRIC STANDARDS

EMC: EN 55014-1, EN 55014-2
SAFETY: EN 60335-1
RoHS: IEC 63000

HYDRAULIC STANDARD

QB2806-2017
EN-817
EN-1111
ASME #112.18.1
ASSE #1016-T,-P*

SANITARY STANDARDS

ACS
KTW/W270
WRAS
NSF61

FLOW RATE DETAIL

MAX FLOW RATE vs TEMPERATURE (3 BAR, DN8)

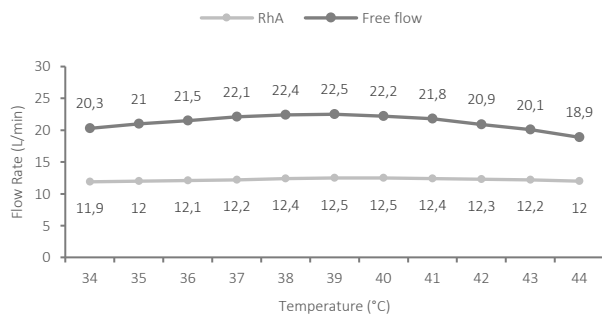

MIX FLOW RATE vs PRESSURE (DN8)

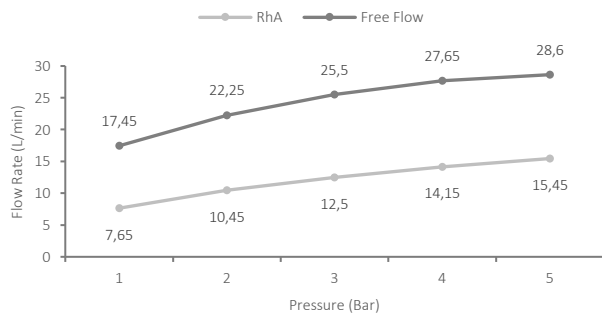

CONNECTIVITY

RS485 Modbus RTU standard with open memory map registers to control the device.

TECHNICAL DIMENTIONS

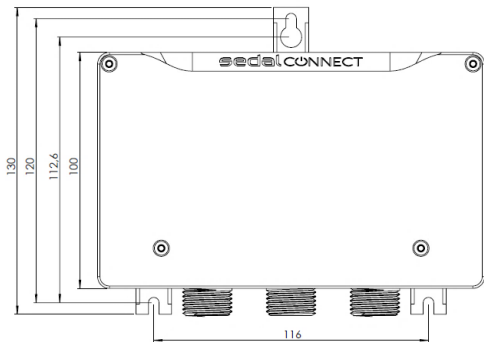
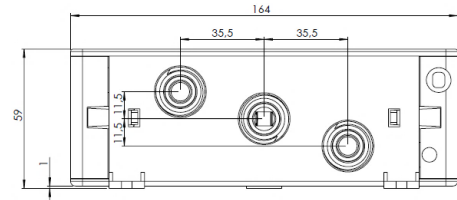

INSTALLATION REQUIREMENTS

Installation of filters Mesh 80 in the hydraulic line. Position, size and type of filter must be mounted upstream of the mixer and acc. to EN817/ASME 112.18.1M