



# Sense

## HYDRON capacitive electronic system

**27ES000007**

### Description

Electronic system for capacitive faucet to be connected to the body's faucet.

### Technical specifications

Voltage supply	DC 6V
Working pressure	1 - 7 bar
Pressure resistance closed (1min)	35 bar
Life cycle	500.000 cycles
Max. hot water	55°C
Flow rate (RhA)	8 l/min
Sensor activation time	< 1 s
Protection against intrusion	IP 65
Power consumption (standby)	< 0.5mW
Power consumption (flushing)	< 3W
Water Saving Function	Auto off adjustable (factory setting 1 min)
Thread	Quick Fitting
Battery type (not included)	4 X AA 1.5V

HYDRON infrared electronic system

27ES000007

## Technical specifications

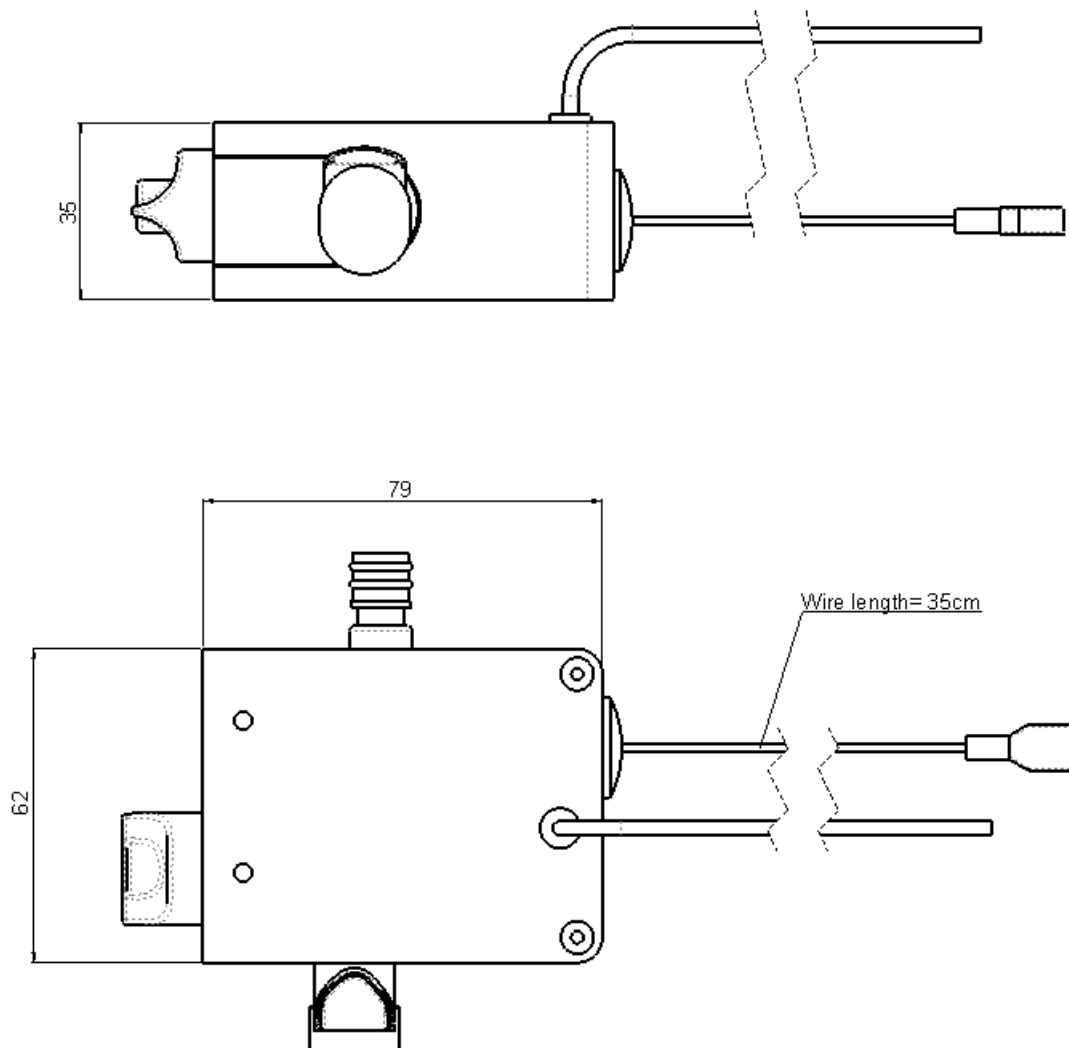

### Other accessories:

- Mechanical mixing valve hot-cold F1/2"/ M1/2"-M1/2 Ref.1616010
- Mechanical mixing valve hot-cold F1/2"/ M3/8"-M3/8" Ref.1616011