

### H3 Urinal Kit

Electronic water valve & Interface

## Versions

AC 27EG004002 H3 Urinal AC

DC 27EG004001 H3 Urinal DC

AC/DC 27EG004003 H3 Urinal AC

## Technical Specifications

### General

Technology	Latch valve with IR sensor
Hydraulic connections	G1/2
Life test EN-15091	210.000 cycles

### Electrical parameters

Input voltage	6 V DC (batteries) 100-240 V AC (wall plug)
Power cut-off protection	Yes (AC powered)
Undervoltage protection	Yes (DC powered)

### Temperature

Max. inlet temperature	45 °C
Min. inlet temperature	>0 °C

### Pressure

Max. dynamic	7 bar (0,7 MPa)
Min. dynamic	0,5 bar (0,05 MPa)
Recommended dynamic	3 bar (0,3 MPa)
Burst (closed valve)	>25 bar (2,5 MPa)

### Flow rate

Outlet DN8 (adjustable)	0-10,2 L/min
Free flow (adjustable)	0-11,6 L/min
Volume class (max. flow)	2 L

### IR sensor

Pre-adjusted detection distance (white card)	75-80 cm
--	----------

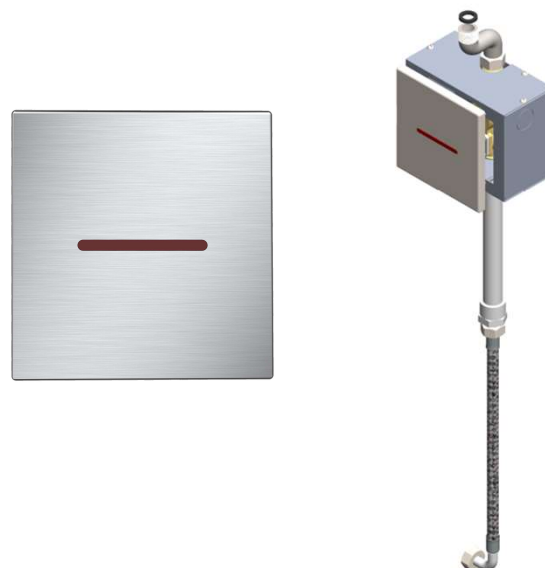

## Description

The H3 electronic kit includes a single-inlet valve for urinal applications, an infrared (IR) sensor, and all required accessories. The system operates fully automatically, with natural IR presence detection and no user action required. This operation enhances hygiene and ensures consistent water savings, making the solution ideal for public facilities as well as private communities. The ON/OFF valve is housed inside a wall-mounted box, while the sensor frame remains visible and provides an unobtrusive, integrated appearance. The system can be powered by batteries, an external power supply, or a combination of both.

## Features

- Infrared presence sensor with adjustable detection range (factory adjustment). The sensor includes a LED light providing feedback to the user.
- Once the user approaches the urinal, the system performs an initial pre-flush. After the user leaves, the system triggers the main flush with adjustable duration (factory adjustment).
- Water saving features:
  - Pre-flush is not activated if the time between users is short. Main flush is not activated unless sufficient presence is detected by the sensor.
  - Valve body includes a flow regulator.
- Bistable latch valve provides a fast response and low power consumption.
- Low pressure feature: valve can operate at low pressure pipelines.
- Different power options are available, covering a wide range of needs:
  - DC: battery pack 4 x 1,5 V (AA).
  - AC: wall plug.
  - AC/DC: hybrid supply.
- Integrated inlet filter within the valve body.
- Screws and anchors for wall mounting included.

### Certifications

#### Electric Standards

EMC EN 55014-1, EN 55014-2

SAFETY: EN 60335-1

#### Hydraulic Standards

EN-15091

#### Regional Standard

CE

UKCA

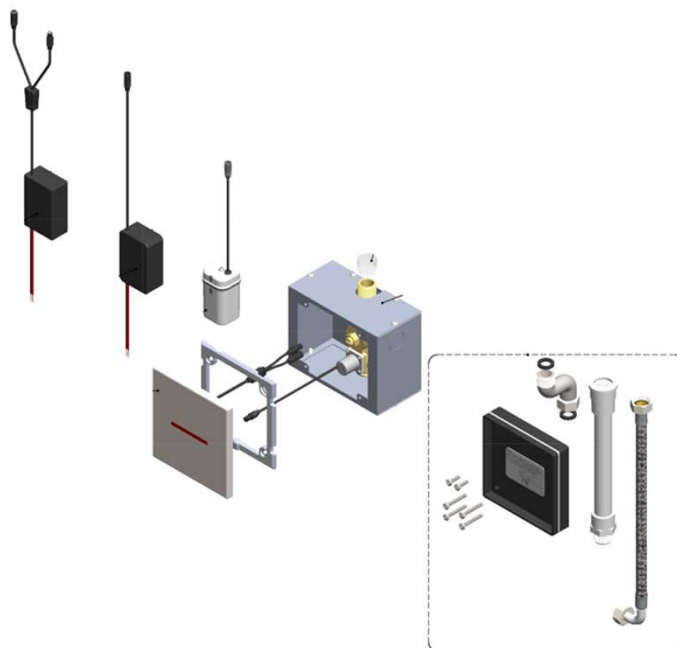

### Technical Dimensions

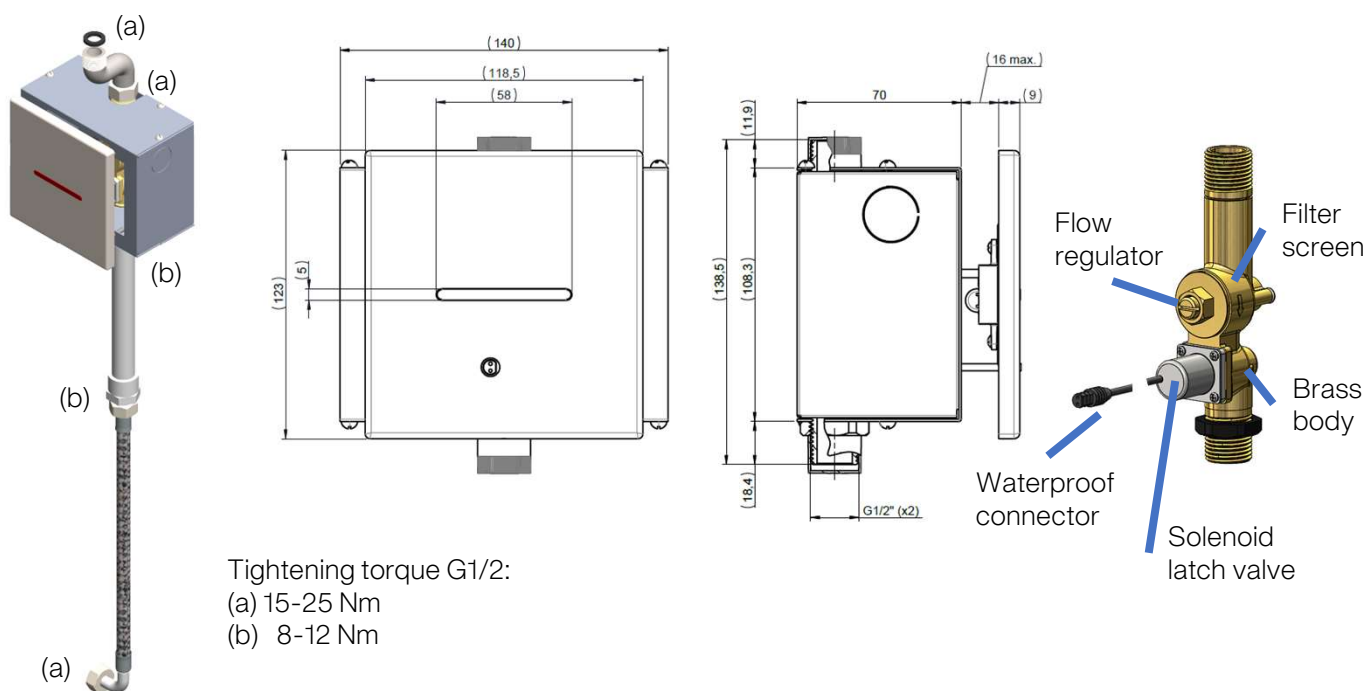

Tightening torque G1/2:

(a) 15-25 Nm

(b) 8-12 Nm

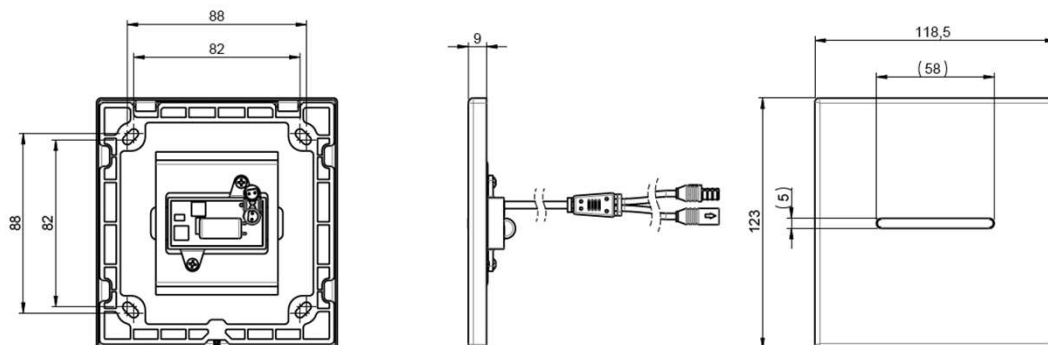

Tightening screws M4: 1,0-1,5 Nm

More information: [www.sedal.com](http://www.sedal.com)

Technical drawing of the valve assembly, showing dimensions and cable connection details.

**Top View Dimensions:**

- Overall width:  $48.2 \pm 0.3$
- Overall height:  $47 \pm 0.3$
- Top mounting hole diameter:  $\varnothing 3.2 \pm 0.1 (x2)$
- Top mounting hole spacing:  $35 \pm 0.3$
- Bottom mounting hole diameter:  $\varnothing 3.2 \pm 0.1$
- Bottom mounting hole spacing:  $24 \pm 0.2$
- Internal width:  $25.2 \pm 0.2$
- Internal height:  $11 \pm 0.2$
- Internal width (lower):  $7.4 \pm 0.2$
- Internal height (lower):  $40 \pm 0.3$

**Side View Dimensions:**

- Top mounting hole diameter:  $2.2 \pm 0.1$
- Top mounting hole spacing:  $5.2 \pm 0.1$
- Bottom mounting hole diameter:  $2 \pm 0.1$
- Bottom mounting hole spacing:  $13 \pm 0.2$
- Maximum depth:  $9 \text{ max.}$

**Cable Connection Details:**

- Wiring:  $26 \text{ AWG} - \text{UL AWM STYLE 2464}$
- Waterproof male DC connector - 2 pins (Cable to valve)
- Waterproof female DC connector - 2 pins (Cable to power supply)
- Wire gauge:  $24 \text{ AWG}$
- Connector pin spacing:  $11.8 \pm 0.2$
- Connector pin diameter:  $\varnothing 3 \times 2$
- Overall cable length:  $210 \pm 10$
- Cable diameter:  $\varnothing 3.5$
- Power supply cable diameter:  $\varnothing 6$

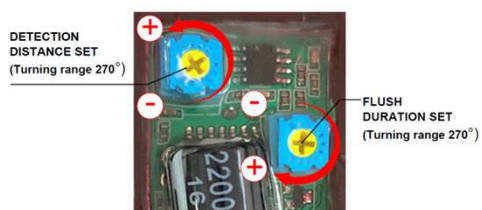

	Min. Value	Preset value	Max. Value
Pre-flush duration (s) (±1 s)	-	4	-
Flush duration (s) (±1 s)	2	9	17
Detection distance (standard White card 250x200 mm) (mm) (±10%)	500	700	1100
Detection distance (Kodak grey 18% card 250x200 mm) (mm) (±10%)	260	450	700

NOTE: Pre-flush time cannot be adjusted

More information: [www.sedal.com](http://www.sedal.com)